

LED track light

IL-1957X

Catalog #		Type
Project		
Comments		Date
Prepared by		



Specification:

Specially design for COB spot light,tigh & simplified,unique concept image guarantees and outanding visual element..

Adopting ADC12 die-casting aluminium radiator with good heat dissipation.

Die-casting aluminum material ,included the front cover, driver box and body, multiple aluminum reflector combination to satisfy with high-end shop lighting project.

3-phase track adaptor compatible with global Nordic track, single phase track compatible with HALO track, easy to maintain and replace COB chip and driver.

Famous brand chip and cUL listed isolated power supply, safe and reliable.

Constant current and Dimming are available.

Additional information:

- **Finish color:** White, Black, Silver grey
- **Socket type:** COB LED
- **Volts:** 120V / 277V
- **Maximum wattage:** 20 watt
- **Lumen:** 1600 lm
- **PF:** >0.9
- **CRI:** 80+/90+
- **CCT:** 2700-6000K
- Triac Dimmable Optional and Constant current
- **Switch:** hardwired
- **Reflector lens material and color:** frosted opal / clear glass
- **Beam angle:** 15D & 24D & 36D
- **Photometric:** IES file & optical sphere file are separate

Mounting:

Track mounting for 3-phase track compatible with global universal track, Single-phase track compatible with Halo track system

Electrical:

Input Voltage: 120V/277V AC 50/60 Hz

Location :

Dry

Certificate:

ETL & cETL.

Warranty:

Five-years warranty.

DIMENSIONS:

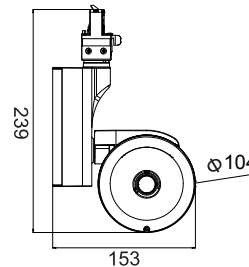

Accessories are available

